

Auto transformers: ~1 230 V, 50Hz ~3 400 V, 50Hz

- Compact design
- Installation feet and connection terminals
- Max. ambient temperature +40° C
- Used for switch cabinet

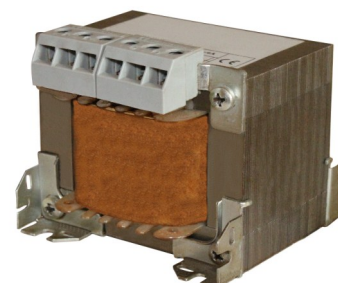

Auto transformers for switch cabinet installation with connection terminals to control the rotational speed of voltage controllable motors

Mains supply ~1 230 V, 50 Hz; Output: 80 V / 120 V / 140 V / 170 V / 230 V

Art.-no.	Type name	Max. current, A	Protection class	Weight, kg
PV-4001	Auto transformer ATV 1,5	1,5	IP 00	1,80
PV-4002	Auto transformer ATV 2	2	IP 00	2,14
PV-4003	Auto transformer ATV 3	3	IP 00	2,75
PV-4004	Auto transformer ATV 4	4	IP 00	3,03
PV-4005	Auto transformer ATV 5	5	IP 00	3,42
PV-4006	Auto transformer ATV 7	7	IP 00	5,50
PV-4007	Auto transformer ATV 11	11	IP 00	7,80
PV-4008	Auto transformer ATV 14	14	IP 00	8,20

Mains supply ~3 400 V, 50 Hz; Output: 130 V / 170 V / 220 V / 270 V / 400 V

Art.-no.	Type name	Max. current, A	Protection class	Weight, kg
PV-5001	Auto transformer ATT 1	1,0	IP 00	2,17
PV-5002	Auto transformer ATT 2	2,0	IP 00	2,83
PV-5003	Auto transformer ATT 3	3,0	IP 00	4,02
PV-5004	Auto transformer ATT 4	4,0	IP 00	6,30
PV-5005	Auto transformer ATT 5	5,0	IP 00	7,30
PV-5006	Auto transformer ATT 7	7,0	IP 00	9,10
PV-5007	Auto transformer ATT 11	11,0	IP 00	14,30
PV-5008	Auto transformer ATT 14	14,0	IP 00	15,60

The company reserves the right to make changes to technical data without prior notice

ATV connection diagram

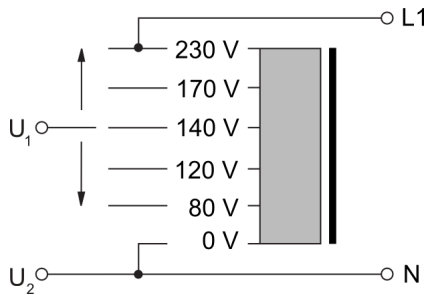

ATT connection diagram

Two transformers in V-connection are connected for three-phase current

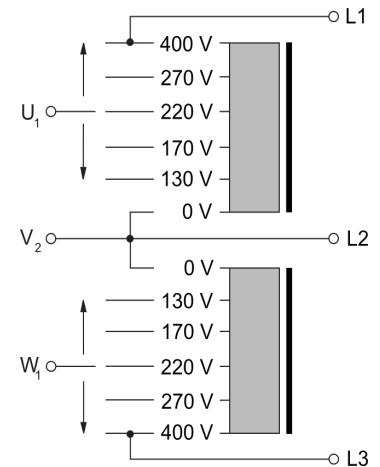

ATV dimensions, mm

Type name	Max. current, A	H	W	D	A	B	C
Auto transformer ATV 1,5	1,5	80	96	62	80	64	45
Auto transformer ATV 2	2	80	96	70	80	64	55
Auto transformer ATV 3	3	88	105	78	87	70	57
Auto transformer ATV 4	4	81	97	94	80	64	76
Auto transformer ATV 5	5	87	105	100	87	70	80
Auto transformer ATV 7	7	100	120	110	100	80	85
Auto transformer ATV 11	11	113	135	110	112,5	90	85
Auto transformer ATV 14	14	125	150	115	125	100	90

ATT dimensions, mm

Type name	Max. current, A	H	W	D	A	B	C
Auto transformer ATT 1	1,0	80	96	71	80	64	52
Auto transformer ATT 2	2,0	81	96	80	80	64	61
Auto transformer ATT 3	3,0	87	105	100	87	64	80
Auto transformer ATT 4	4,0	101	121	110	100	80	85
Auto transformer ATT 5	5,0	113	135	108	113	90	83
Auto transformer ATT 7	7,0	125	150	115	125	100	97
Auto transformer ATT 11	11,0	125	150	160	125	100	130
Auto transformer ATT 14	14,0	125	150	175	125	100	143

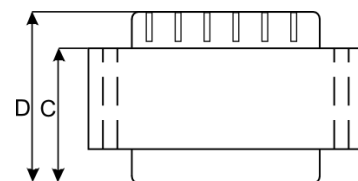
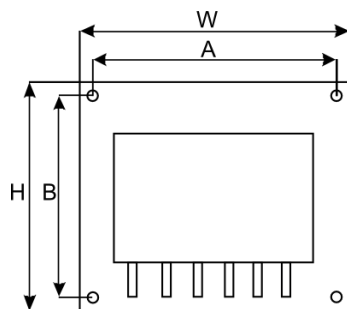

The company reserves the right to make changes to technical data without prior notice